



특징 (Character)

- 크랭크 레버를 사용한 광각형 각도개폐방식
Wide angular type by crank lever driving unit
- 링크레버 타입보다 저유격실현 및 내마모성 향상
Low gap and wear resistance improvement beside link lever type
- 다양한 크기의 제품 생산으로 선택의 편리성 추구
Pursued convenience of selection by manufacturing various sizes.
- 개폐검출 센서 전기종 부착가능
Magnetic sensor is available for open-close sensing



AF101
AF02
AF03
AF04P
AF105P
AF06
AF10
AF13
AF13C
AF14
AF15
AF316
AF17
AF117
AF19
AF24
AF26
AF28D
AF30
AF30L
AF30SP
AF40
AF46
AF56N
RAF56N
MF16

크랭크 레버 방식 (Link lever type)

작동 방식 (Kinetics)

크랭크 레버 작동에 의한
넓은 각도 개폐 방식
wide angular type by crank
lever driving unit

구동부 (Drive)

복동식
double acting
pneumatic cylinder

조 (Jaws)

파지부
for gripping

취부위치 (Mounting and positioning)

다면 취부가 가능
mounting possible from several
sides for versatile positioning

몸체 (Body)

경질 처리된 경량의
알루미늄 합금
high-tensile aluminum body with
lightest possible because of
hard anodizing

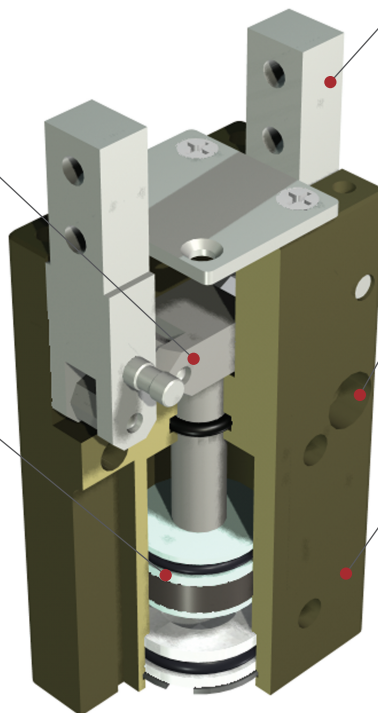

부품분해도 (Exploded view)

※ 본 분해도에는 한 제품을 예시하였으므로 기종별로 차이가 있을 수 있습니다
 ※ This is exploded view illustrates a certain product only. The contents may vary by product models.

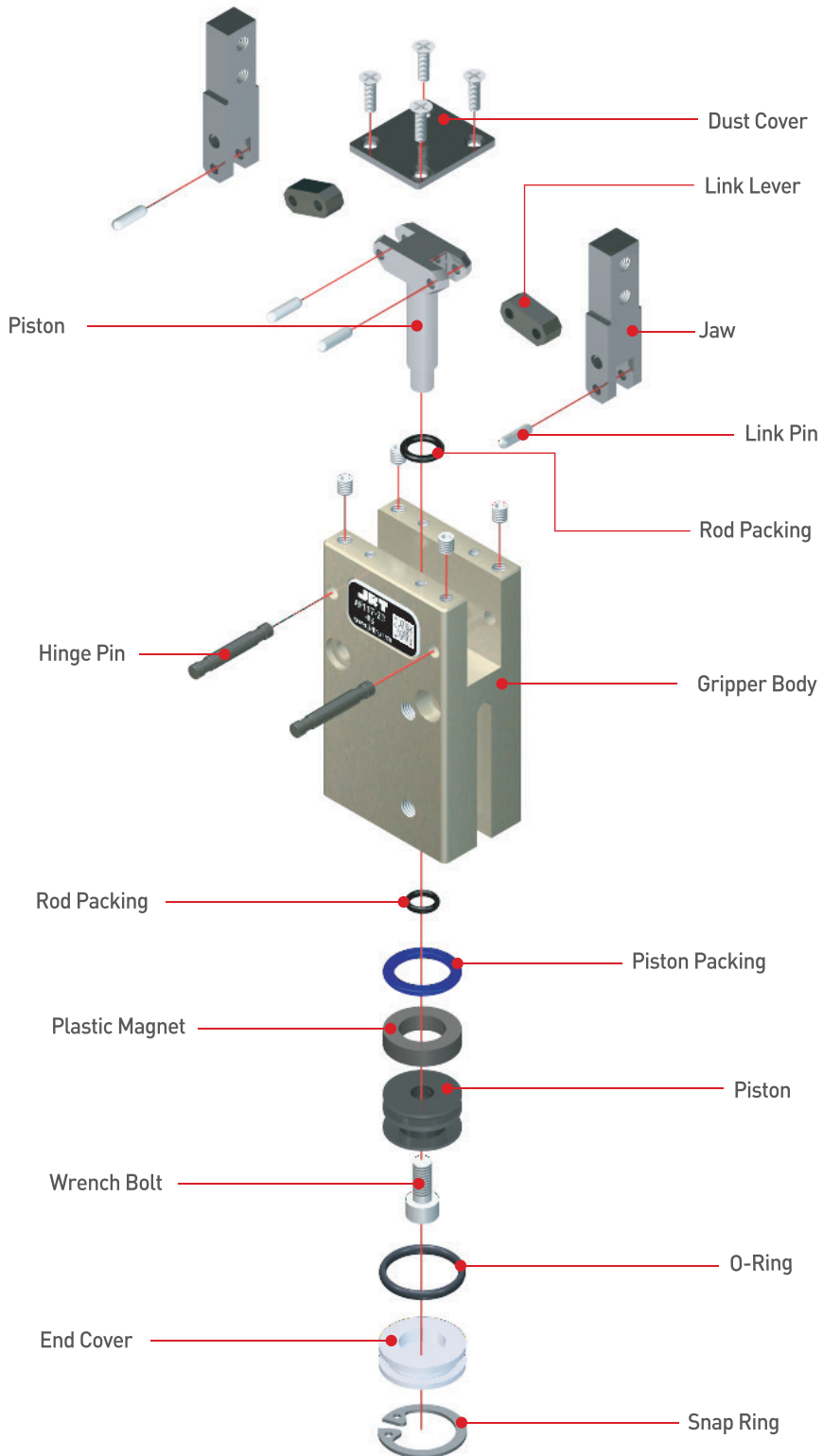

주문기호 (Ordering Code)

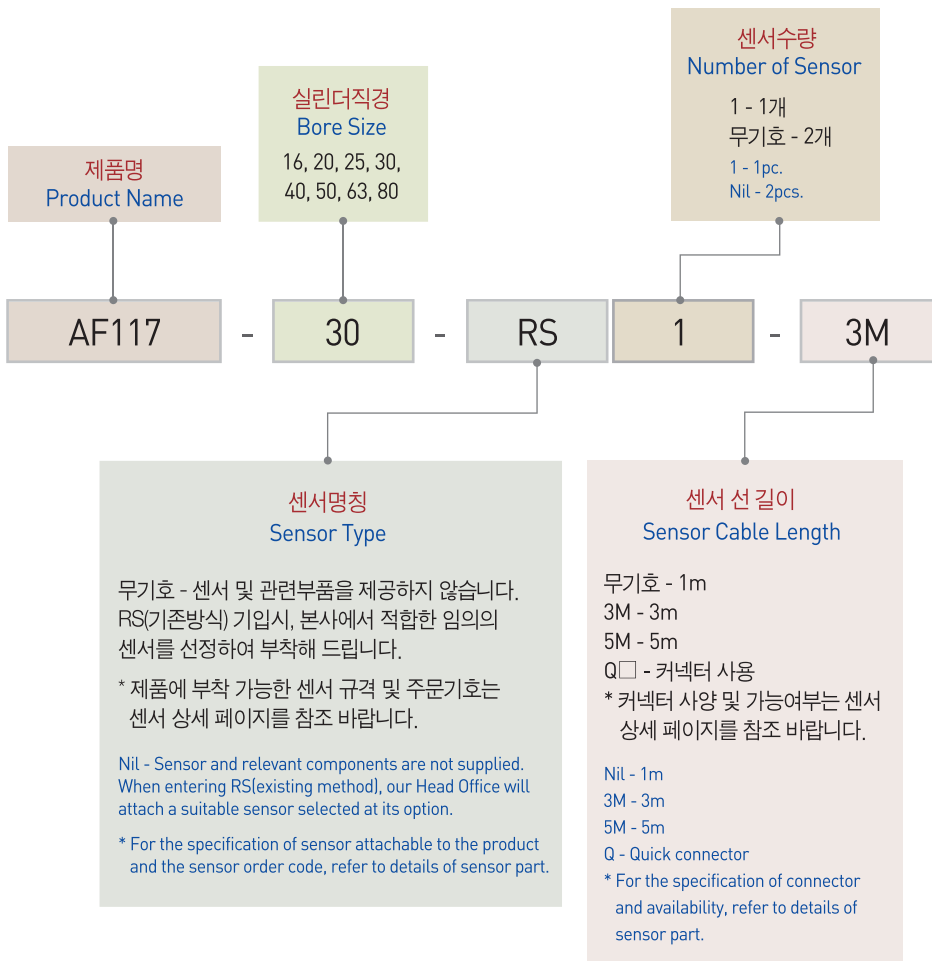

- AF101
- AF02
- AF03
- AF04P
- AF105P
- AF06
- AF10
- AF13
- AF13C
- AF14
- AF15
- AF316
- AF17
- AF117**
- AF19
- AF24
- AF26
- AF28D
- AF30
- AF30L
- AF30SP
- AF40
- AF46
- AF56N
- RAF56N
- MF16

☐ 제품사양 (Specification)

P=공기압력(bar) , L=작동점까지의 거리(mm)
P=Air Pressure(bar) , L=Exertion length(mm)

제품명칭 Products Name	AF117-16	AF117-20	AF117-25	AF117-30	단위 Unit
개폐범위 Stroke	0 to 180	0 to 180	0 to 180	0 to 180	degree
제품중량 Weight	0.21	0.27	0.38	0.69	kg
최대치구길이 Max. length attach	30	40	50	60	mm
배관접속구 Fitting size	M5	M5	M5	PF(G) 1/8	
파지력 : 열림시 Gripping force : Open	36.30(P-0.3)/0.1L	51.01(P-0.5)/0.1L	56.90(P-0.1)/0.1L	63.77P/0.1L	N
파지력 : 닫힘시 Gripping force : Close	31.39(P-0.3)/0.1L	44.15(P-0.5)/0.1L	51.01(P-0.3)/0.1L	55.92P/0.1L	N
1사이클당 공기소모량 Air consumption per cycle	4.3	9.9	15.4	33.4	cm ³
닫힘시/열림시 시간 Closing / Opening time	0.01/0.01	0.01/0.01	0.02/0.02	0.04/0.04	sec
반복정밀도 Repeat accuracy	0.2	0.2	0.2	0.2	mm
연속사용회수 Continuation usage amount	60	60	60	40	cpm
사용압력 Operating pressure	3~7				bar
주위온도 Ambient temperature	-5 to 60				℃
윤활 Lubrication	불필요 Needless				

제품명칭 Products Name	AF117-40	AF117-50	AF117-63	AF117-80	단위 Unit
개폐범위 Stroke	0 to 180	0 to 180	0 to 180	0 to 180	degree
제품중량 Weight	1.2	2.17	3.5	6.65	kg
최대치구길이 Max. length attach	70	75	125	150	mm
배관접속구 Fitting size	PF(G) 1/8	PF(G) 1/8	PF(G) 1/8	PF(G) 1/8	
파지력 : 열림시 Gripping force : Open	136.36P/L	308.03P/L	607.24P/L	1177.20P/L	N
파지력 : 닫힘시 Gripping force : Close	116.74P/L	253.10P/L	544.46P/L	1059.48P/L	N
1사이클당 공기소모량 Air consumption per cycle	68.4	148.1	301.9	583.3	cm ³
닫힘시/열림시 시간 Closing / Opening time	0.07/0.07	0.15/0.15	0.30/0.30	0.60/0.60	sec
반복정밀도 Repeat accuracy	0.2	0.2	0.3	0.4	mm
연속사용회수 Continuation usage amount	40	30	30	20	cpm
사용압력 Operating pressure	3~7				bar
주위온도 Ambient temperature	-5 to 60				℃
윤활 Lubrication	불필요 Needless				

반복정밀도 : 연속 100회 작동후 측정치
After 100 consecutive strokes to end positions

작용점에서의 파지력 (Gripping Force From a Point of Action)

범례(Legend) : — 7[bar] — 5[bar] — 3[bar]

- AF101
- AF02
- AF03
- AF04P
- AF105P
- AF06
- AF10
- AF13
- AF13C
- AF14
- AF15
- AF316
- AF17
- AF117**
- AF19
- AF24
- AF26
- AF28D
- AF30
- AF30L
- AF30SP
- AF40
- AF46
- AF56N
- RAF56N
- MF16

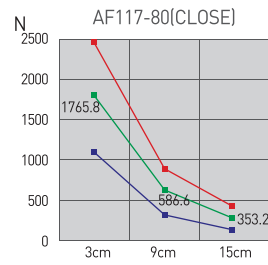
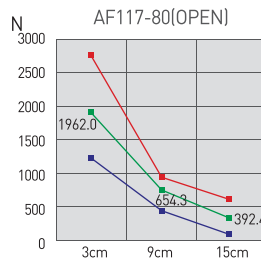
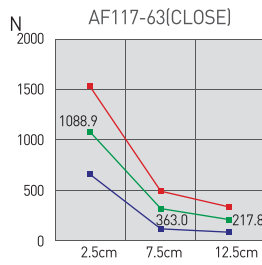
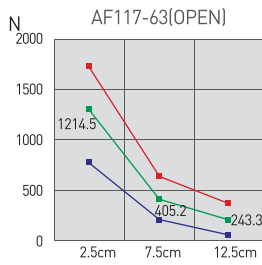
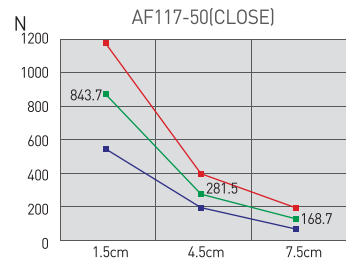
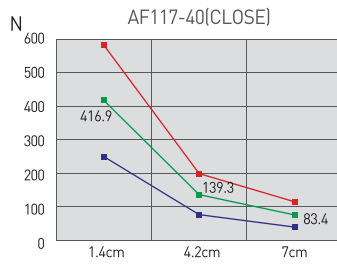
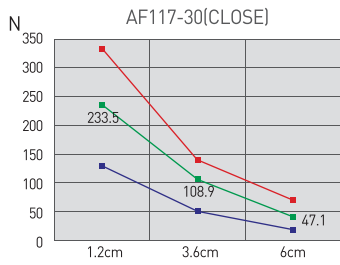
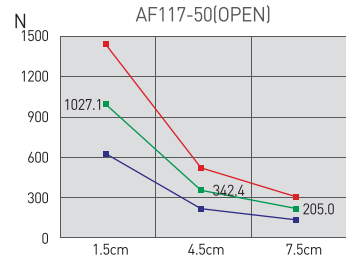
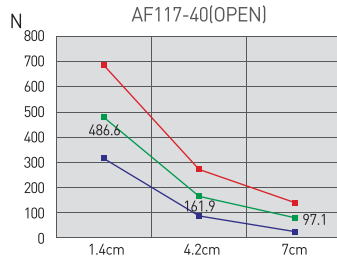
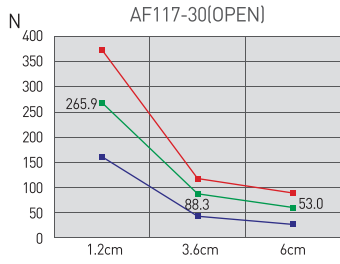
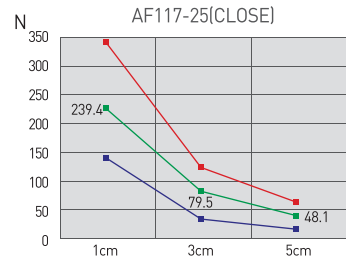
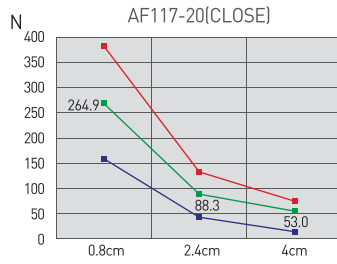
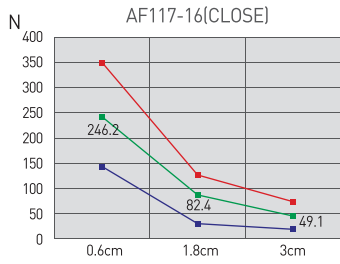
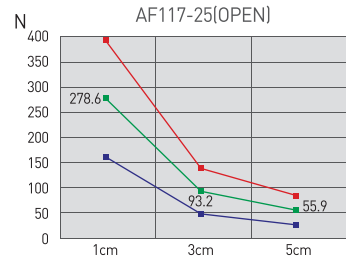
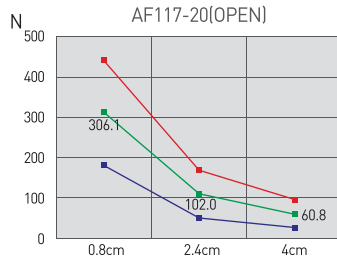
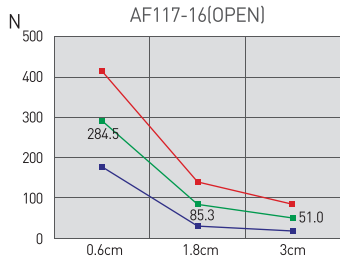

AF117-16

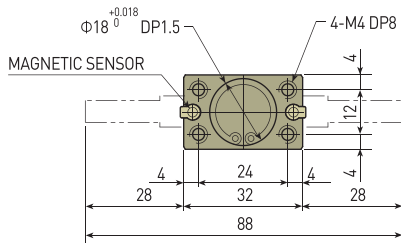
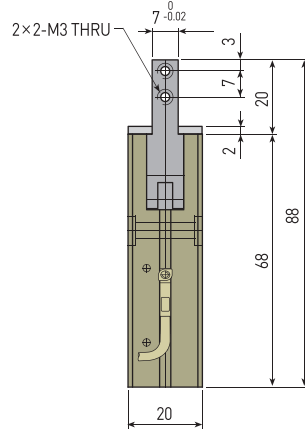
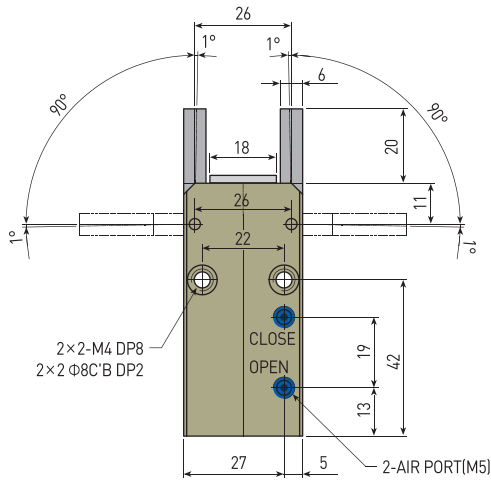

AF117-20

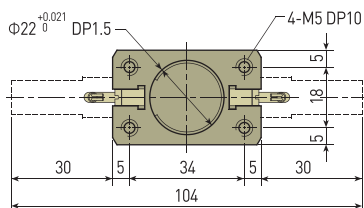
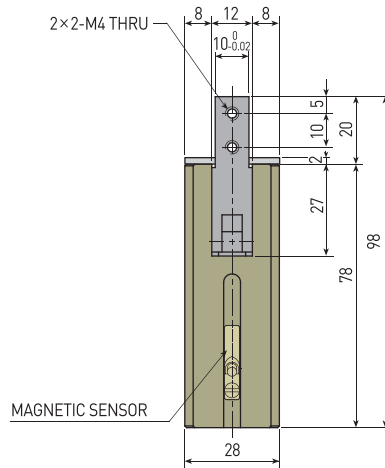
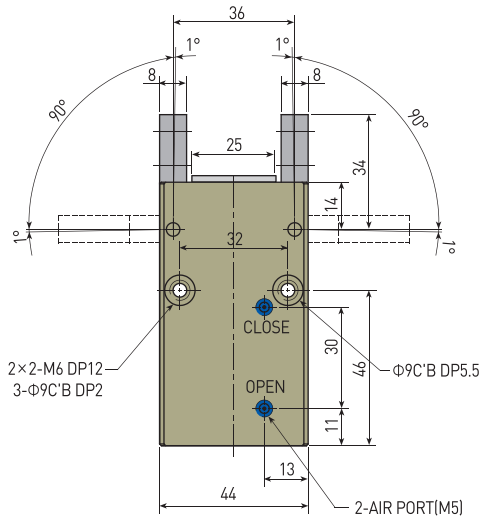

AF117-25

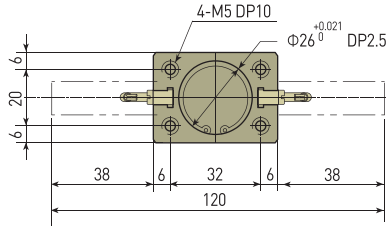
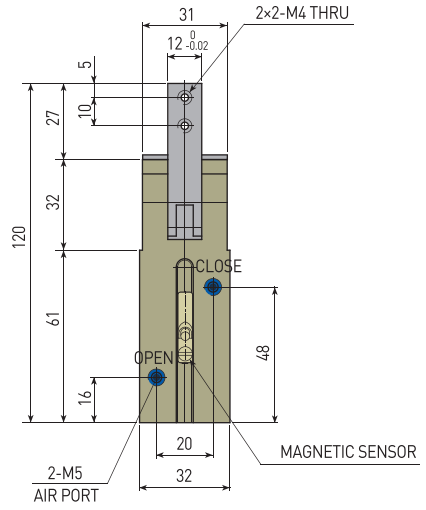
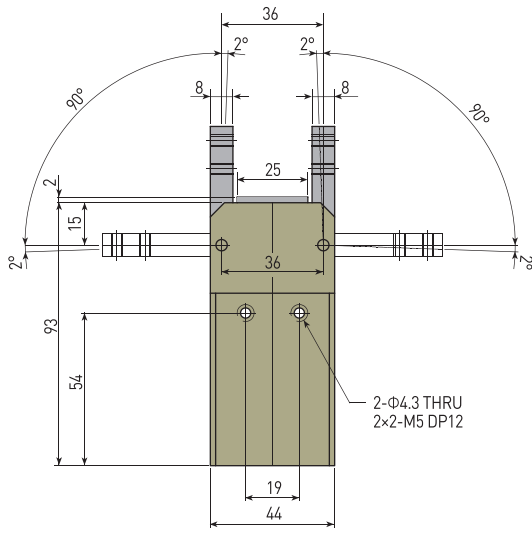

AF117-30

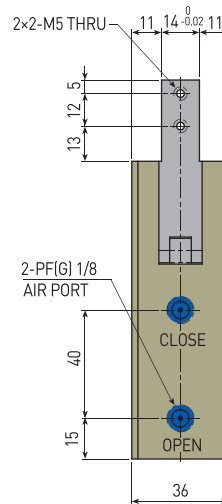
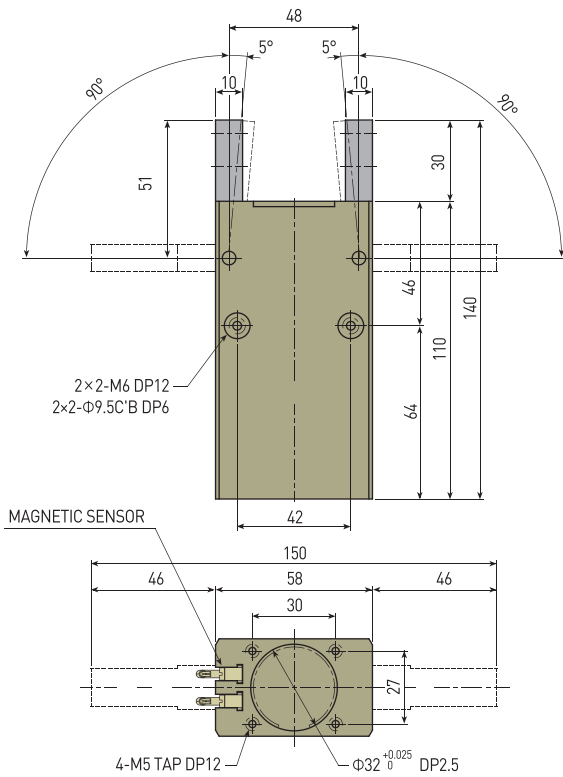

- AF101
- AF02
- AF03
- AF04P
- AF105P
- AF06
- AF10
- AF13
- AF13C
- AF14
- AF15
- AF316
- AF17
- AF117**
- AF19
- AF24
- AF26
- AF28D
- AF30
- AF30L
- AF30SP
- AF40
- AF46
- AF56N
- RAF56N
- MF16

AF117-40

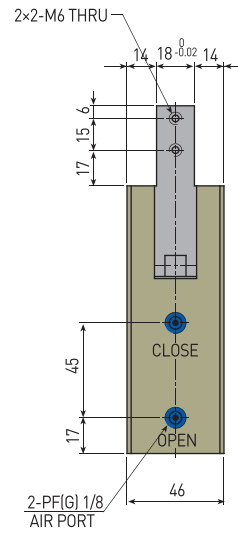
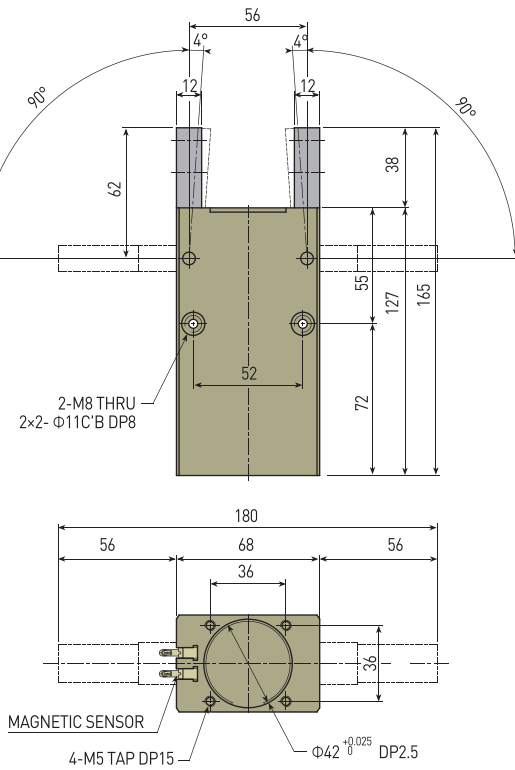

AF117-50

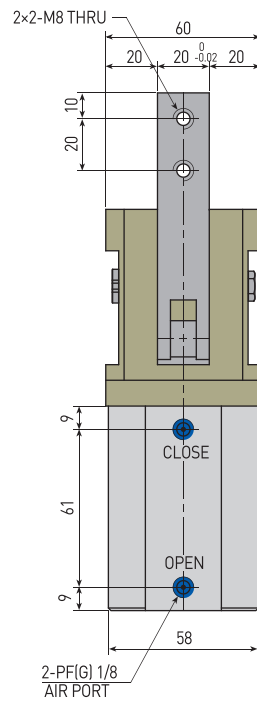
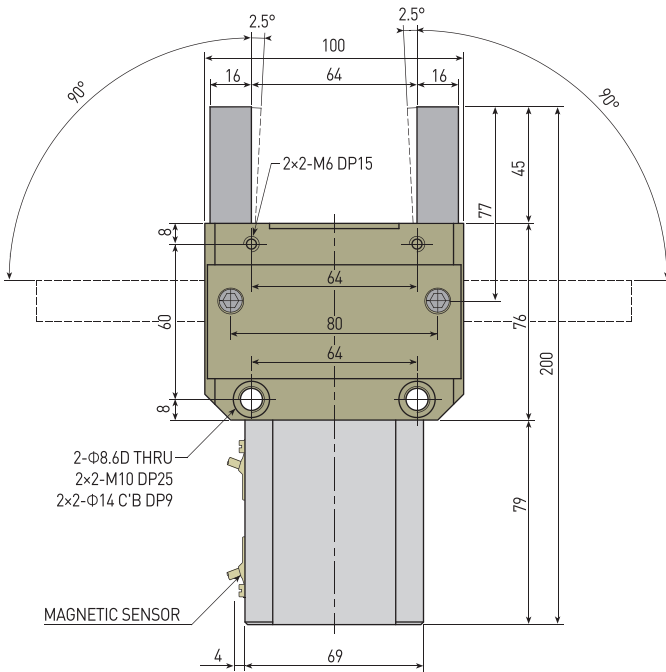

AF117-63

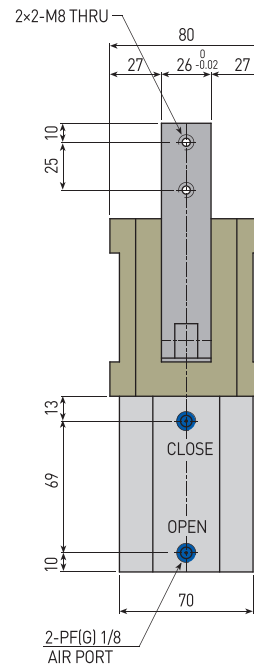
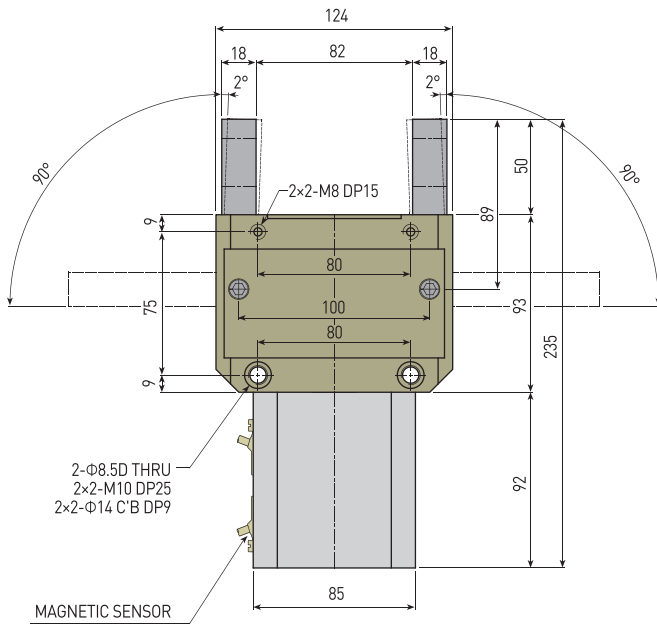

AF117-80

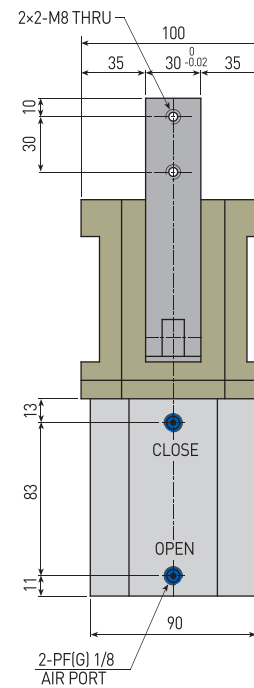
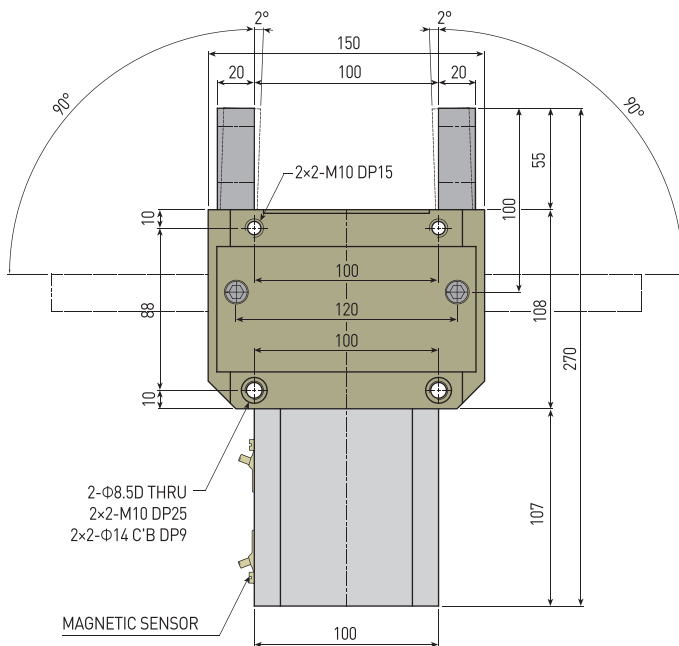

- AF101
- AF02
- AF03
- AF04P
- AF105P
- AF06
- AF10
- AF13
- AF13C
- AF14
- AF15
- AF316
- AF17
- AF117
- AF19
- AF24
- AF26
- AF28D
- AF30
- AF30L
- AF30SP
- AF40
- AF46
- AF56N
- RAF56N
- MF16